

# OPERATIVE MANUAL



The tool complies with Directive 2001/95/CE relative to general safety of the products in observance of the following rules:

- UNI EN 614-1:2009 Ergonomic principles of design. Section 1: Terms and general principles.
- UNI EN 614-2:2009 Ergonomic principles of design. Section 2: Interaction between machine design and operative jobs.
- UNI EN ISO 14121-1:2007 Machine safety. Risk analysis. Section 1: Principles
- UNI EN ISO 12100-1:2009 Machine safety. Main notions, general principles of design. Section 1: Terms, ground methods.
- UNI EN ISO 12100-2:2009 Machine safety. Main notions, general principles of design. Section 2: Specifications and technical principles.
- UNI EN 349:2008 Machine safety. Minimum space to avoid crushing of parts of the body.



---

## Quality Certificate



### CERTIFICATE OF APPROVAL

This is to certify that the Quality Management System of:

**BBA S.r.l.**  
**Via dell'industria, 36**  
**63033 Centobuchi di Montepiccolo (Ascoli Piceno)**  
**Italia**

has been approved by Lloyd's Register Quality Assurance to the following Quality Management System Standards:

**ISO 9001:2008**

The Quality Management System is applicable to:

**Design and manufacture of carbon steel, stainless steel,  
non-ferrous blind nuts and special fasteners.**

Please, read carefully the operating manual for the correct and safe use of the tool

# OPERATIVE MANUAL

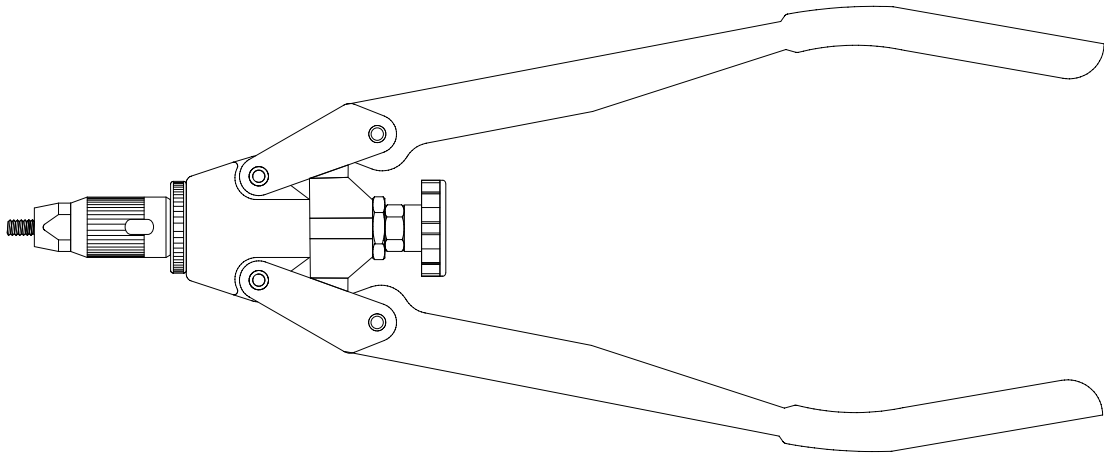

## TOOL KIT

The kit includes:

- Plastic tool case
- Insert hand-tool **KS-08**
- Various types of **BCT Multigrip** rivet nuts M5, M6 and M8
- Adaptator for M5 and M6 ( preinstalled for M8)
- Demo Multigrip bar
- Operative Manual

## TECHNICAL DATA

Weight: gm 1.670  
Dimensions: mm 470 x 110 x 35  
For threads: M4 – M5 – M6 – M8 – M10

### BCT rivet nuts grip-ranges

( the grip range refer only to the BCT supplied with Hand tool )

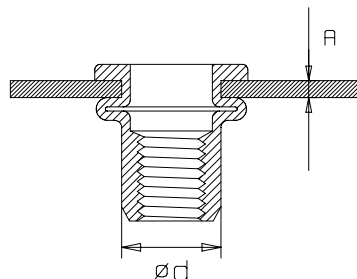

	$\varnothing d$	R
M5	8.0	max. 5.0 mm
M6	9.0	max. 6.0 mm
M8	11.0	max. 8.0 mm

The information contained in this document are subject to modification and updating without notice or duty of notice from **BBA** srl. All trade marks are property of **BBA** srl.

**BBA** srl  
All rights reserved  
2009

## **GENERAL WARNINGS**

- Before using the hand tool it is necessary to carefully read this MANUAL.
- The manufacturer of this tool declines any responsibility for possible damages to things and/or people due to improper use of the tool or to non-compliance with the instructions for use hereafter shown in this Manual.
- Any check, maintenance or operation for which removal of some parts of the tool is required, will be under the complete responsibility of the operator; therefore each operation is to be done exclusively by skilled and technical personnel trained according to the instructions of this Manual.

## **WARNINGS FOR USERS**

- The tool is to be used by one operator only.
- Other people are not allowed to get close while the tool is being used.
- The tool is to be used only by placing one hand on each lever.
- The tool is to be used in a stable position.
- The tool is not appropriate for continuous and repetitive use.
- The operators using and making the maintenance of this tool are to be properly trained on the correct usage and maintenance of the tool.
- The operators must also be informed about the main parts needed for usage, disassembly and maintenance shown in this Manual.

## **TOOL DESCRIPTION**

- The insert-tool is a manual tool specifically designed to place the rivet nuts; no power is needed for its usage.

## HAND TOOL FOR RIVET NUTS FROM M4 UP TO M10

Before using the hand tool it is necessary to check that the nose piece (A1), the screw (A6) and the washer (A5) are the correct size for the rivet nut that is to be placed, if not, it is necessary to change size.

Make sure that when the hand tool is in open position ( with levers at maximum extension) the screw protrudes beyond the nose piece by minimum length same as rivet nut's length.

Warning: when used for the first time after purchase the hand tool is usually set for M8 rivet nuts.

## RUN REGULATION

This type of hand tool has no run regulation so the rivet nut is intended to be placed when the force necessary for fitting reaches the workable limit.

## REGULATION OF THE SCREW

Screw the rivet nut on the screw .

**Important notice** : please, make sure that the screw protrudes out of the rivet nut by 0,5 mm. (0.0197 inches) approx (B). The regulation is obtained by loosening the lock ring (A3); the screw (A6) will come out after screwing the screw protrusion adjuster (A2). Unscrew the screw protrusion adjuster to have the screw get in again, **then tighten again the lock ring once the regulation is finished** .

## CHANGE OF DIAMETER

Follow the instructions below to replace the kit for the change of diameter :

- Loosen the lock ring (A3) .
- keep screw protrusion adjuster (A2) out .
- Loosen the mandrel coupling (A4) by using a 17 key for the mandrel coupling and a 13 key for the hex drive cone (A7) until the parts are separated .
- Replace TCEI screw preinstalled for diameter 8 (A6) with the required screw and apply the washer (A5) (supplied with the M5 and M6 Kit) .
- Assemble again the parts paying attention to have the corners of the inner hexagonal part of the TCEI screw perfectly in line with the hex drive cone edges, then carry on as per instructions n. 3,2,1 .

The Hand tool is equipped with "diameter change kit" for M8 rivet nuts (pre-installed), M 5 and M6, while for M4 and M10, **also inches size 8-32, 10-32, 1/4-20, 5/16**, it can be supplied on request .

## HOW TO PLACE A RIVET NUT

1. Open the levers to maximum extension .
2. Screw the rivet nut to be placed onto the screw .
3. Put the hand tool into the hole .
4. Use the necessary force on the levers to correctly set the rivet nut .
5. Open the levers to maximum extension, unscrew the knob (A8) to release the hand tool from the rivet nut once placed .

A

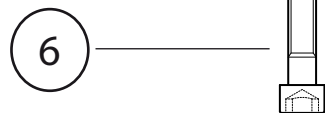
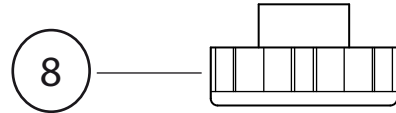
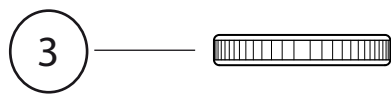
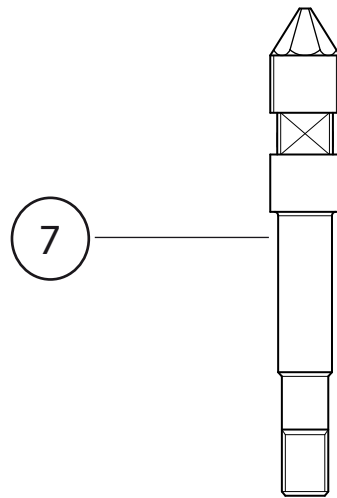
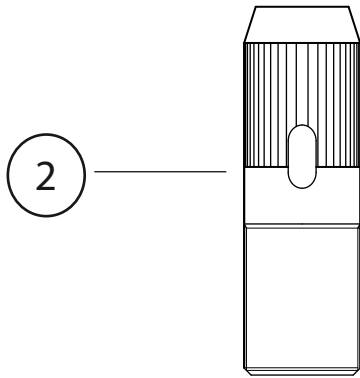

B

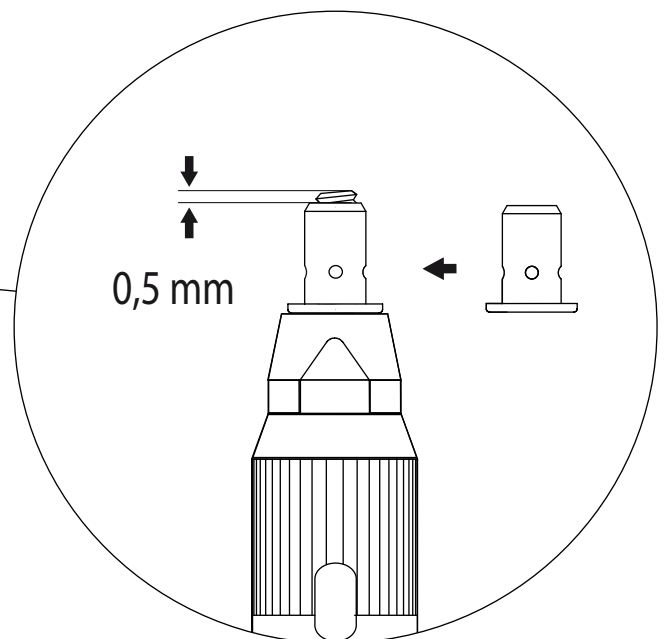
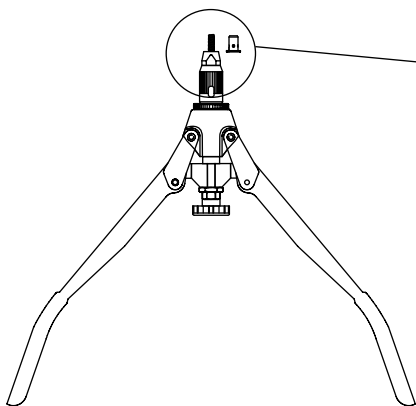

# PARTS

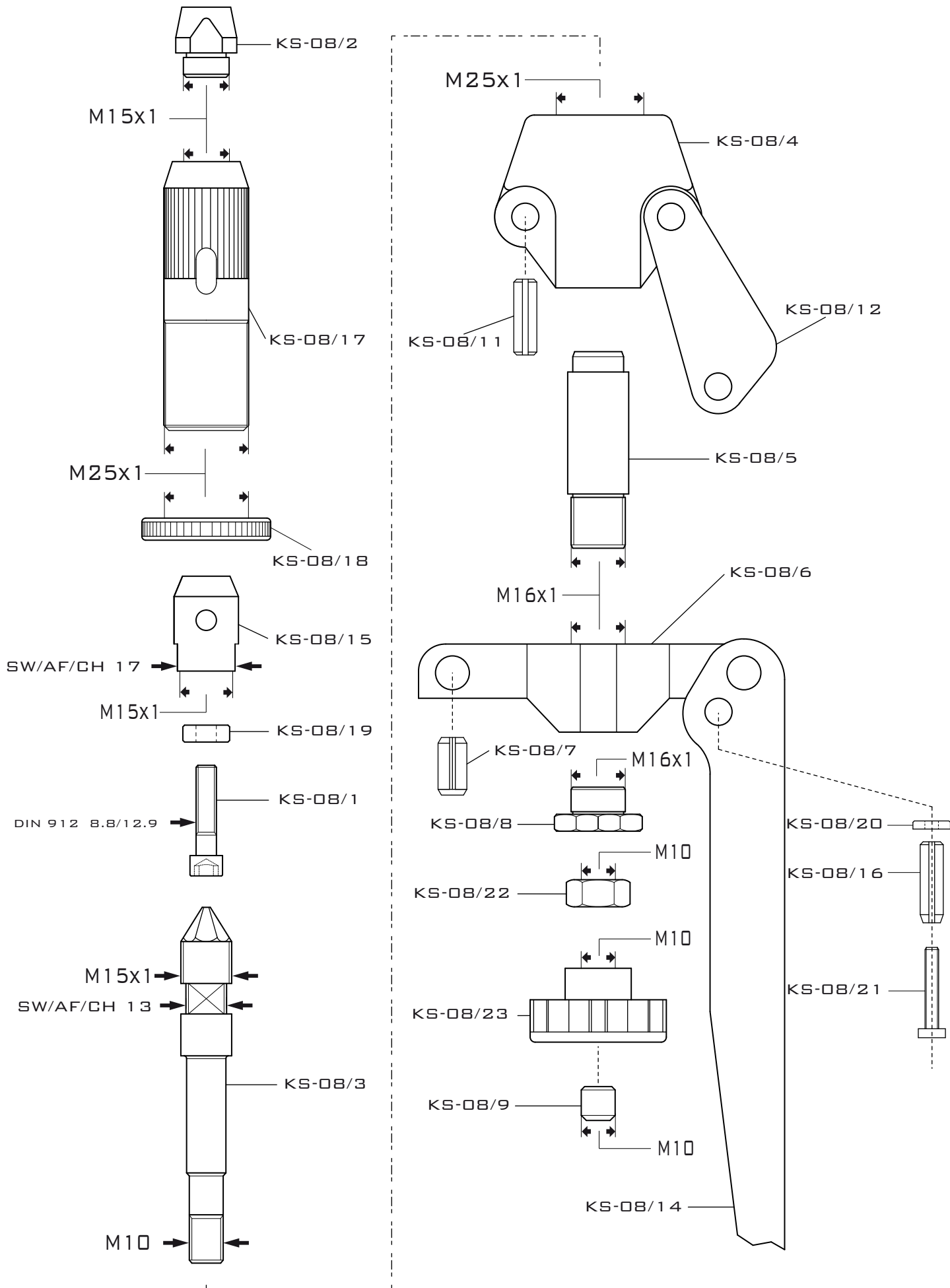

## CLEANING AND MAINTENANCE

The hand tool can be easily cleaned by using a dry or slightly oiled cloth . Dust or dirt can be removed by air jet .

The hand tool does not need special maintenance . It's only necessary to disassemble periodically the inner parts and clean them as indicated above to get an optimal performance .

## GUARANTEE

- This hand tool is under one year warranty on the mechanical parts as of purchase date .
- The guarantee is valid only if the hand tool has been used properly according to the instruction of this manual .
- This guarantee relieves **BBA srl** as manufacturing company from any responsibility for direct and/or indirect damages caused by its tools and/or production loss .
- **BBA srl** is not responsible for possible damages to the hand tool caused by bad use .
- Consumables parts are not under guarantee .
- Guarantee covers the right to get replacement of a defective part but not transport cost

## SPARE PARTS

Descrizione	Cod. Prodotto
SCREW M4-M5-M6-M8-M10	KS-08/01/M4-M5-M6-M8-M10
NOICE PIECE M4-M5-M6-M8-M10	KS-08/02/M4-M5-M6-M8-M10
HEX DRIVE CONE	KS-08/03
ALLUMINIUM HOUSING	KS-08/04
LEADING TUBE	KS-08/05
CROSS MEMBERS	KS-08/06
EXPANSIONS PIN Ø 10x18	KS-08/07
LOCK NUT	KS-08/08
HEX NUT M10	KS-08/09
EXPANSIONS PIN Ø 8x29	KS-08/11
DRIVE BRACKETS	KS-08/12
LEVER	KS-08/14
MANDREL COUPLING M4 - M8	KS-08/15
MANDREL COUPLING M10	KS-08/15/M10
EXPANSIONS PIN Ø 8x27	KS-08/16
SCREW PROTRUSION ADJUSTER	KS-08/17
LOCK RING	KS-08/18
WASHER M4-M5-M6	KS-08/19/M4-M5-M6
ROUND NUT M5	KS-08/20
CHEESE HEAD SCREW M5 x 30	KS-08/21
HEXNUT M10	KS-08/22
KNOB	KS-08/23





WHAT A STANDARD BLIND NUT CAN NOT DO

**BCT** can

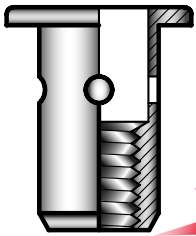

just some samples

MULTIGRIP

M6 from 0.5-6.0 mm M10 from 1.0-10.0 mm  
M8 from 0.5-8.0 mm M12 from 1.0-12.0 mm

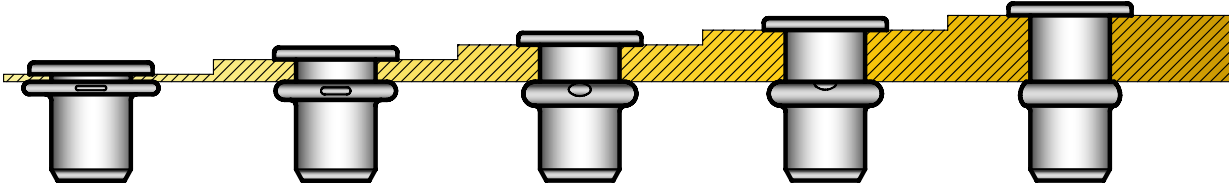

HIGH STRENGTH FOR USE WITH 12.9 SCREWS

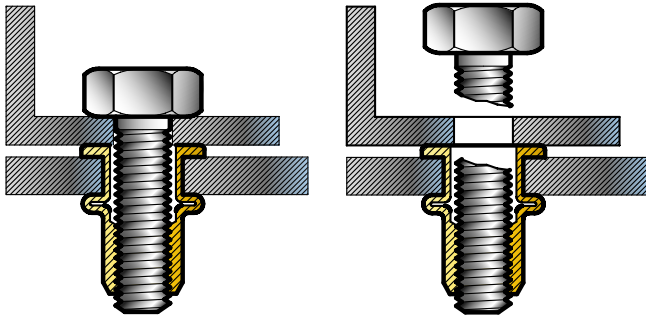

to draw panels together

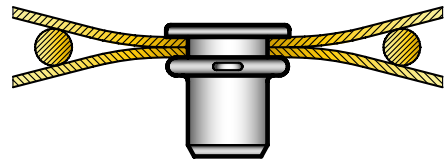

USE IN SOFT MATERIALS

or sandwich sections

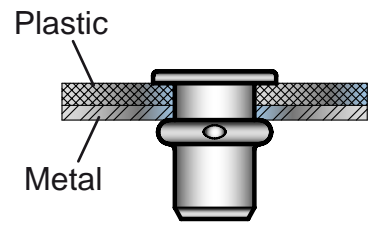
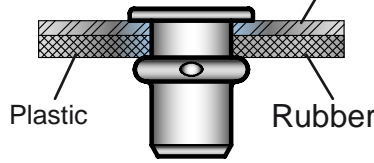
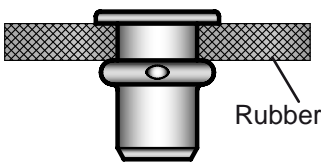

REDUCED HEIGHT - NO PROBLEM

even this is possible

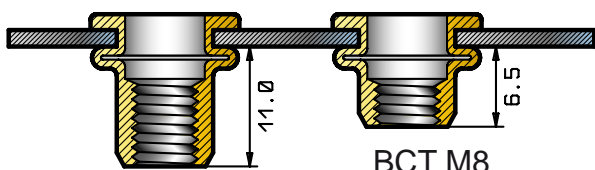

Standard M8

BCT M8  
the thread takes  
same load as  
standard

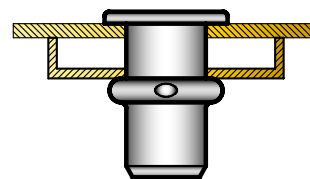

# Index

Preface	.....	Pag. 1
Warnings	.....	Pag. 2
User manual	.....	Pag. 3
Figure A - B	.....	Pag. 4
Figure C	.....	Pag. 5
Cleaning and maintenance	.....	Pag. 6
Note	.....	Pag. 7
BCT Rivet Nut	.....	Pag. 8
Index	.....	Pag. 9

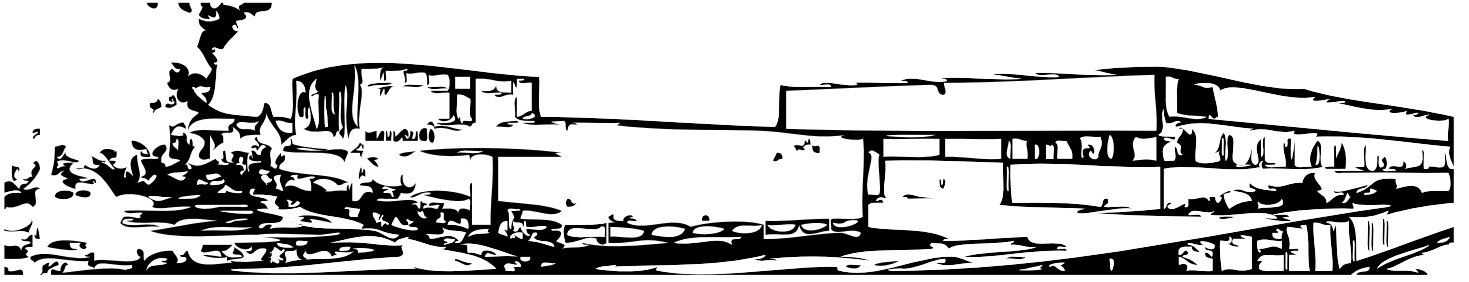

Via Dell'Industria, 38 I-63076 Monteprandone (AP) Italy

Tel.: 0039 0735 714056

Fax.: 0039 0735 714057

WEB: [www.bbafasteners.com](http://www.bbafasteners.com)

E-mail: [info@bbafasteners.com](mailto:info@bbafasteners.com)

Sales: [bba.srl@tin.it](mailto:bba.srl@tin.it)

Made in Italy